

A 编码

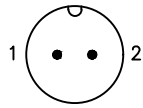

2Pin

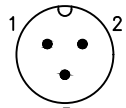

3Pin

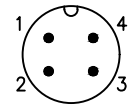

4Pin

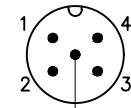

5Pin

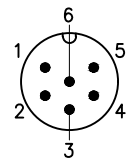

6Pin

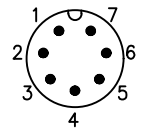

7Pin

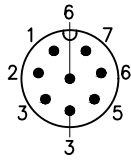

8Pin

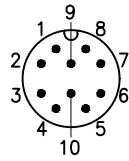

10Pin

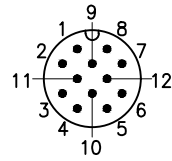

12Pin

B 编码

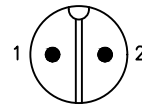

2Pin B

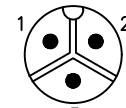

3Pin B

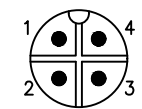

4Pin B

C 编码

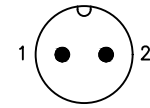

2Pin C

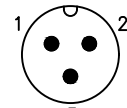

3Pin C

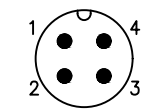

4Pin C

芯数	2P	3P	4P	5P	6P	7P	8P	10P	12P	2P B	3P B	4P B	2P C	3P C	4P C
额定电压	60V	60V	60V	60V	60V	60V	60V	30V		300V	300V	300V	125V	125V	125V
额定电流	5A	5A	5A	5A	5A	5A	5A	2A	2A	10A	10A	10A	10A	10A	10A
防水等级	IP67/IP68														
使用温度	-45°C~105°C														

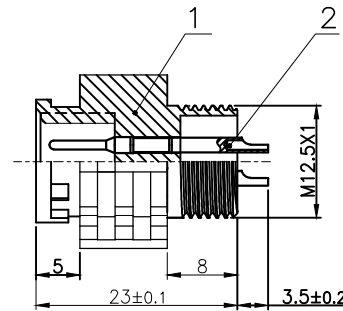
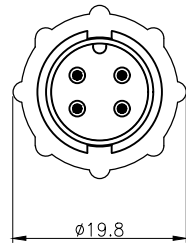

E系列 插针:

- 2~12P: E系列 1.0焊线式公针长针
- 2~4P B: E系列 1.6焊线式公针长针
- 2~4P C: E系列 1.6焊线式公针长针

技术参数

- 连接方式: 卡扣连接
- 接线方式: 焊线
- 污染等级: 3
- 插拔周期: ≥500

所有材料均符合RoHS要求

材料

- 外壳材料: 增强尼龙, 黑色
- 接触体材料: 黄铜, 镀金
- 绝缘体材料: 增强尼龙, 黑色
- 密封材料: 橡胶, 黑色

GENERAL TOLERANCE (UNLESS SPECIFIED)

- ≤10 ±0.1
- <10~≤20 ±0.2
- <20~≤50 ±0.5
- Angle ±1°

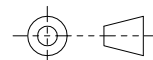

THIRD ANGLE

DWN	DATE
L.L	2022.8.15
CHK	DATE
APVD	DATE

UNIT	REV
MM	A
SIZE	SHEET
A4	1 OF 1



TITLE E10 卡扣式针型对接插头半成品

PART NO

DRAWING NO E10P-BK-Px

2	E系列 焊线式公针长针	黄铜	镀金	pc	2~12
1	E10 卡扣式针型对接插头外壳	尼龙	/	pc	1
No.	Specification	Material	Treat	Unit	Q'ty